

We say
Yes
to getting
the job
done right



Learn how to fit shelving

brackets



SCAN TO
DOWNLOAD



DECOR

Find your local store using
our Store Locator at

www.buildit.co.za

Free

42

Build it

Yes We Can!

Fitting fixed shelving
using shelf

brackets



B

FITTING FIXED SHELVING USING SHELF BRACKETS

Need some extra shelving? Follow this guide to get the job done perfectly.

TOOLS REQUIRED

- Pencil
- Spirit level
- Drill
- Screwdriver
- Step ladder
- Tape measure

MATERIALS REQUIRED

- Wooden shelf
- Shelf brackets
- Wall plugs
- Wall screws

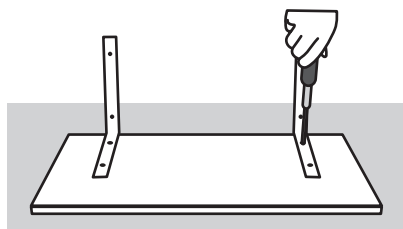

STEP 1:

Select the correct bracket spacing, then attach the shorter arm of each bracket to the underside of the shelf, flush with the rear edge.

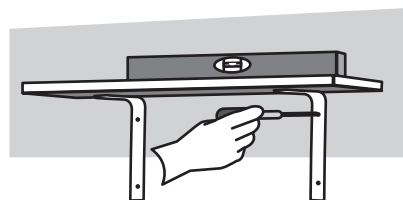

STEP 2:

Fix the shelf to the wall with a screwdriver through one bracket, then check that it is horizontal with a spirit level and mark all the remaining screw positions.

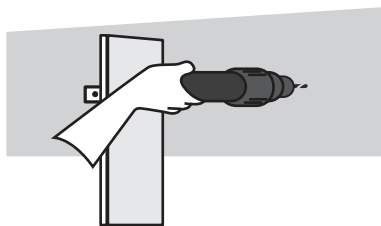

STEP 3:

Let the shelf swing downwards on its first fixing screw, then drill the other holes. Insert plugs for masonry wall fixings if needed.

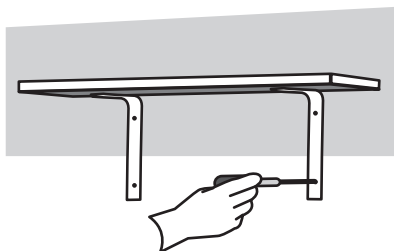

STEP 4:

Swing the shelf back up into position and drive in the remaining fixing screws. Tighten them fully so that the screw heads pull the brackets against the wall.

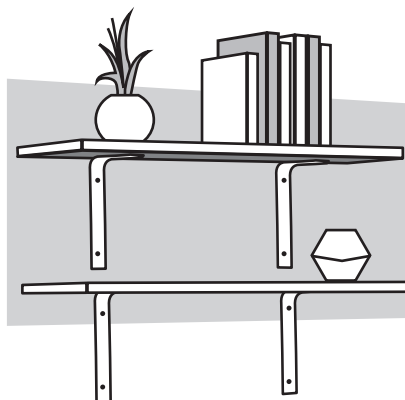

Individual brackets can be used to mount more than one shelf, as long as there is no need to change the shelf spacing in the future.

Find your local store using
our Store Locator at www.buildit.co.za

Build it
Yes We Can!