



**Build it** plus

## Plan your next D.I.Y. project right from the start.

These Build It D.I.Y. brochures have been compiled especially for you to help you through every step of your home D.I.Y. projects.

We've given you expert advice on what materials you'll need and step-by-step instructions on how to get the job done right, first time.

Please feel free to visit any of our stores and speak to one of our consultants on advice about your projects.

We say  
**Yes**  
to getting  
the job  
done right



Learn how to  
**adjust** the hinges  
to align cupboard doors



SCAN TO  
DOWNLOAD



FASTENERS

Find your local store using  
our Store Locator at

[www.buildit.co.za](http://www.buildit.co.za)

Free

37

**Build it**

*Yes We Can!*

**Adjusting**  
hinges on  
misaligned doors



## ADJUSTING HINGES ON MISALIGNED DOORS

If your cabinet doors are out of alignment and you have European-style hinges, no problem. Hinges are designed for easy adjustment. Don't let their complex look scare you. All you have to do is turn a few screws, and any mistakes you make are easy to correct.

### TOOLS REQUIRED

- Step ladder
- Star or flat screwdriver
- Level

The Euro hinge depicted here adjusts in three directions. Others adjust in two directions. Either way, it's a trial-and-error process. You make adjustments, close the door to check the fit, then adjust again until it's right.

### STEP 1

If the door isn't flush with the doors next to it, adjust the depth screw. This screw moves the door in and out. Some depth screws move the door as you turn them. With most though, you have to loosen the screw, nudge the door in or out and then tighten the screw. If your hinges don't have depth screws, start with the side screws.

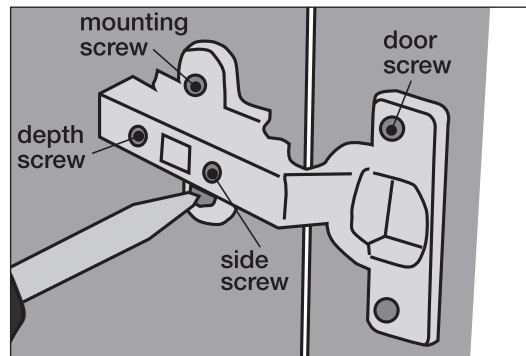

### STEP 2

If the door is crooked, not standing parallel to adjacent doors or square with the cabinet, adjust the side screw. This moves the door from side to side. In some cases, you have to loosen the depth screw slightly to adjust the side screw.

### STEP 3

If the door is flush and parallel with other doors but too high or low, use the mounting screws to raise or lower the mounting plates. Loosen the screws at both hinges, slide the door up or down and tighten the screws. Some mounting plates adjust by turning a single screw.

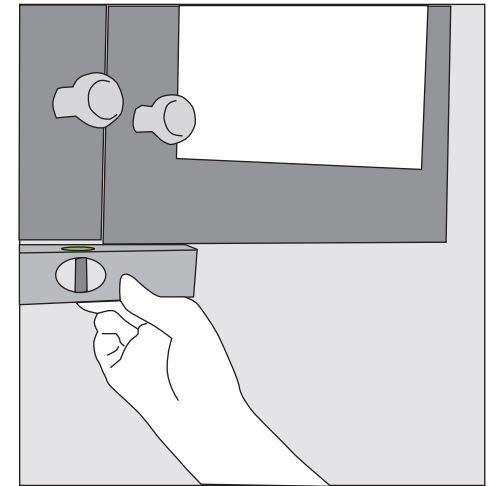

**Step 1.** Tighten the door screws and mounting screws before you make any adjustments. Then adjust the depth screw and side screw.

**Step 2.** Check the fit of the door after each adjustment. With double doors like these, perfect the fit of one door first, then align the other door.

Find your local store using  
our Store Locator at [www.buildit.co.za](http://www.buildit.co.za)

**Build it**  
Yes We Can!