



Build it plus

Welcome to Build It Plus



Build It Plus

Plan your next D.I.Y. project right from the start.

These Build It D.I.Y. brochures have been compiled especially for you to help you through every step of your home D.I.Y. projects.

We've given you expert advice on what materials you'll need and step-by-step instructions on how to get the job done right, first time.

Please feel free to visit any of our stores and speak to one of our consultants on advice about your projects.

We say **Yes** to getting the job done right



Enhance your **privacy** by erecting a wooden fence



SCAN TO DOWNLOAD



FENCING

Find your local store using our Store Locator at

www.buildit.co.za

Free

22

Build it

Yes We Can!

Erecting a **WOODEN** Fence



HOW TO ERECT A WOOD FENCE

The application chosen here is to erect a small fence between a brick built garage and the neighbour's fence, thus making your garden area more private. The fence will be subject to a lot of force from the wind as it is in an open area, so ensuring that it is sturdy and correctly erected is important.

TOOLS REQUIRED

- Spade
- Level
- Saw
- Drill
- Builders Line
- Hammer
- Tape Measure

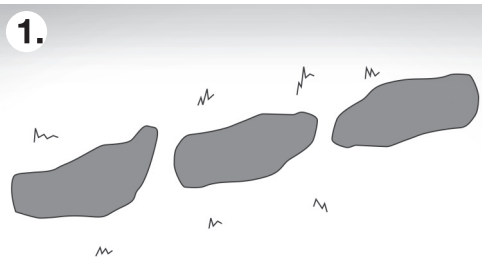

This project is meant to provide a screen between your house and the neighbour's fence. The fence will only span about 2438mm and one side will be attached to the neighbour's fence. By adding more posts, the fence can be extended. Dig three holes, 500mm deep and fill with 50mm of gravel/stone.

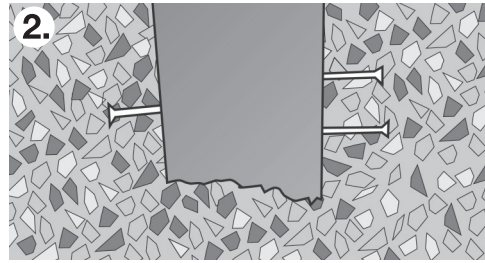

Attach 76mm nails to that section of the post that will be covered by concrete. Three per post. This will secure the posts in the concrete and make it difficult for them to be pulled out.

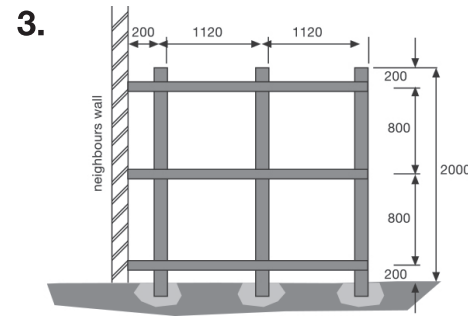

Insert three 76 x 76mm timber posts in the holes, 2450mm long. The length above ground level should be ± 2000 mm. Level the posts and screw a 50 x 76mm batten across the three posts, 200mm above ground level. Use 76mm galvanized wood screws for this, two per fixing. The end of the batten can be fixed to the neighbor's fence with an aluminum angle cleat.

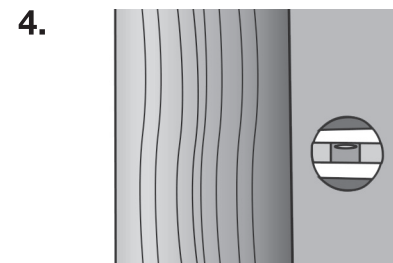

Ensure the posts are vertical and level with each other. Use temporary bracing to keep posts in place.

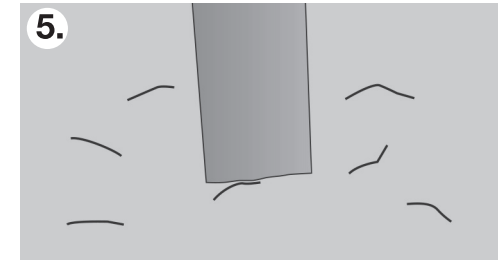

Fill holes with concrete and leave to set for 24 hours. For this job, premix concrete can be purchased in bags. Use one bag per hole.

As per pic 3, screw the other two 50 x 76mm battens onto the posts at the positions shown. There should now be three posts, with three horizontal battens. The structure is now ready to receive the vertical fence panels.

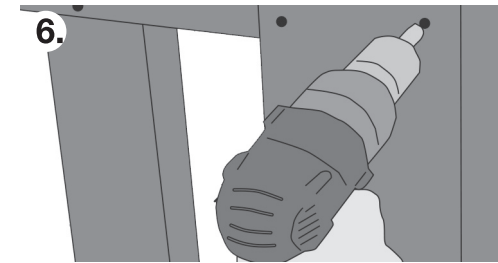

Using a cordless drill, fix 25 x 100 x 2000mm fence panels to the horizontal battens using 38mm galvanized screws. Two per fixing. The panels must be butted up against each other. Make sure that the top of the fence panels are in a straight line. Use a builders line to check this.

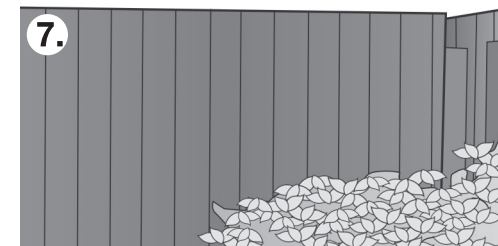

The complete fence.

Find your local store using
our Store Locator at www.buildit.co.za

Build it
Yes We Can!