



Build it plus

Welcome to Build It PLUS



Pro

Plan your next D.I.Y. project right from the start.

These Build It D.I.Y. brochures have been compiled especially for you to help you through every step of your home D.I.Y. projects.

We've given you expert advice on what materials you'll need and step-by-step instructions on how to get the job done right, first time.

Please feel free to visit any of our stores and speak to one of our consultants on advice about your projects.

We say **Yes** to getting the job done right



Yes you **can** build your own braai



SCAN TO DOWNLOAD



BUILDING

Find your local store using our Store Locator at

www.buildit.co.za

Free

20

Build it

Yes We Can!

Building a Braai



HOW TO BUILD A BRAAI

You can buy a braai in every conceivable shape and size from any number of different outlets, but if you are serious about braaing and enjoy your DIY, what could be more satisfying than building your own? The materials that make up this braai are relatively expensive and it will last for years.

TOOLS REQUIRED

- Tape Measure
- Spirit Level
- Square
- Brick Laying Trowel
- Chisel
- Club Hammer

BUILDING A BRAAI

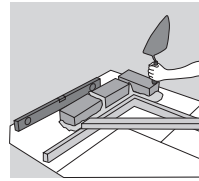

Make a wooden frame to act as a template guide to the dimensions of the grill kit. Lay the bricks out dry (without mortar) to enable the correct brickwork bond to be determined. Bed the bricks on a bed of mortar made up of 5 parts soft building sand to one part of cement, with plasticiser added to keep the mix supple.

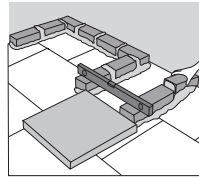

Use a spirit level to ensure the brickwork is level and plumb. Here, a paving slab is being used to act as a tabletop. Lay the slab down as a guide to the independent leg position. You can use a 1 x 0,6m paving slab, or a 0,6 x 0,6m slab like this one.

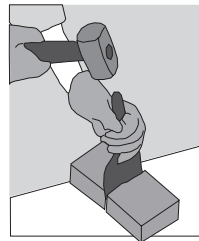

To get the brickwork bond correct, it is necessary to cut half bricks. Cut these on a soft surface with a bolster chisel and club hammer. Wear protective clothing for this operation.

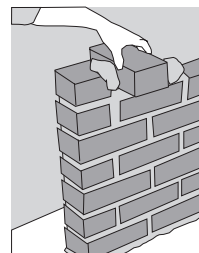

When you have built the brickwork to the correct height for the slab table, turn some of the bricks as shown, so that they act as corbels (supports) for the table and the grate. Ensure that you measure the width of the grate so that you will be sure of a good fit once the grate is in place in the finished braai.

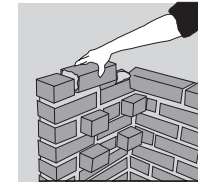

Repeat the corbels two courses up to support the cooking griddle. Again, measure the position of these carefully.

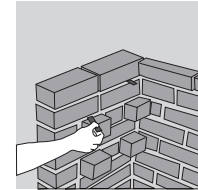

Two more courses of bricks are required to complete the braai. **Option:** Push four metal pins into the mortar below the top course of brickwork to support a warming griddle shelf.

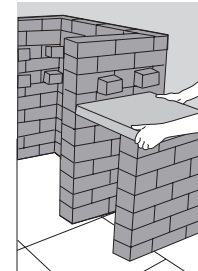

Set the paving slab on a bed of mortar to make a table top alongside the main body of the braai. Leave the brickwork to cure for a couple of hours. The area under the slab can be used to store wood charcoal.

Go to your nearest Build it and purchase a solid metal base that will fit into the brick supports. This will be used to build the fire on. Also purchase a metal grid that is placed onto the

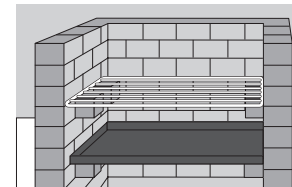

upper level of brick supports that the food is placed on for cooking. A second solid metal base can be placed on the metal pegs above the cooking grid that can be used to keep cooked food warm.

Find your local store using
our Store Locator at www.buildit.co.za

Build it
Yes We Can!