

simply

Hangings Wallpaper



Follow these easy steps to hanging wallpaper and you will find the job easier than you imagined.

TOOLS REQUIRED

Scissors
Level
Pencil
Trestle Table
Hanging Brush
Craft Knife
Bucket
Brush (wallpaper)

Building made simple!

simply Hanging Wallpaper

MIXING YOUR PASTE

Mix your paste in a bucket according to manufacturers instructions. Follow these instructions carefully, as they will vary according to the type of paper you are hanging.

You may alternatively, purchase a ready-mix paste suitable to the paper you are hanging.

You will also need a large pasting brush to apply your paste with.

CUTTING THE PAPER

Measure the lengths of the first "drop" of paper. Add three or four inches to this to allow for trimming both ends.

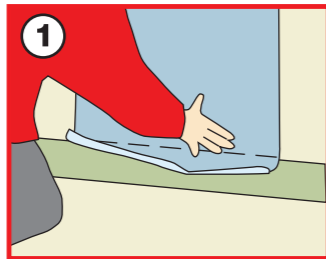

With first piece face up on table, unroll a second piece next to it, aligning the pattern before cutting to length.

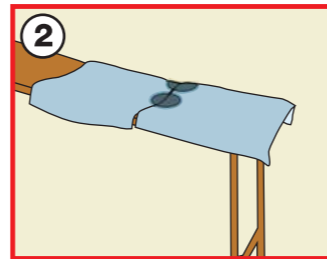

Load your brush and apply the paste along the centre of the piece of paper. Paste the far sides working outwards in a crisscross manner from the centre.

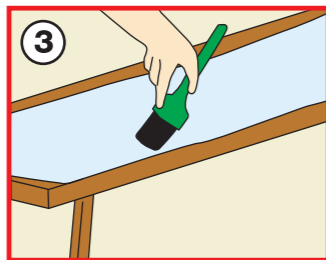

Slide the paper towards you so that it overhangs the near side of the table in the same way as before. Repeat pasting process. You can also apply paste using a roller, but only work in one direction, or you will find the paper being rolled up in it.

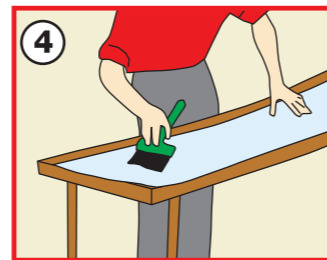

HANGING PAPER

First piece

Take first length of paper and unfold the top end. Leave bottom end folded for the moment. Holding paper in both hands, line up with your vertical mark on the wall. Allow an overlap at top for trimming, gently push paper against wall, making adjustments to its position by gentle sliding.



Using hanging brush, smooth down centre of paper to push out the air. Smooth downwards at an angle towards outer edges either side of the centre. You will avoid creases by working in one direction.

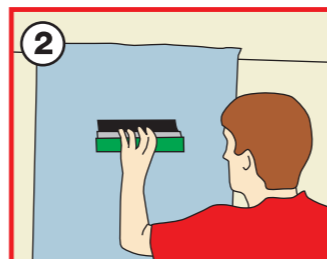

To mark ends for trimming, use back edge of scissors to score a light line along the ceiling or skirting angle.

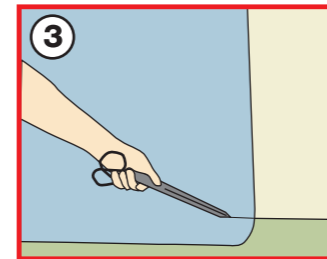

Lift paper away from wall little at a time and trim to this line. Brush paper back down against wall, especially at ends.

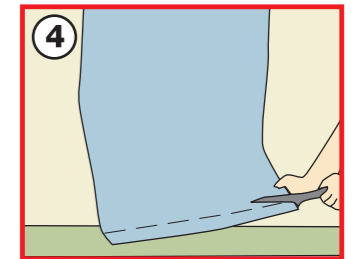

Another trimming option is to use a steel straight edge pushed firmly into angle to be trimmed and cut paper with a craft knife.

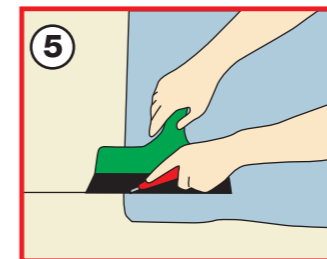

When next drop is pasted and ready to hang, repeat the process. Use edge of previous drop to line up.



It may be easier to position paper on wall, a fraction away from edge of preceding piece and then slide into position. Continue hanging paper in this manner to the end of first wall.



At end of wall, you will need to trim paper into corner. Do not trim exactly to corner, but allow it to run round by about half an inch. This generates a small overlap in corner, which provides a neat finish.

Remaining pieces

The corner is unlikely to be perfectly square. When hanging first piece on next wall, you will need to mark another vertical line.

Building made simple!

simply

Hanging Wallpaper

Slacken the retaining screws for each unit as you get to it.

Hang paper in normal way, allowing it to go over the switch but be careful not to damage it. Press paper lightly over the switch to identify four corners.

Mark these and cut through paper from centre of switch out towards these marks. Gently ease paper back to wall around switch.

Four triangles of paper pointing towards you is what you are left with. Trim these but allow a little to tuck in behind switch cover.

Pull switch plate away from wall and gently brush these pieces behind it. Reposition switch and gently tighten screws.

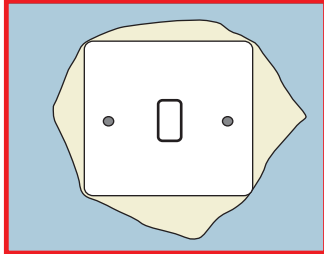

Hang paper lightly over item.

Mark centre and cut from nearest edge of paper to this point. Make radial cuts out from this mark. Push paper back into place. Mark flaps where they meet the edge of the item and trim before brushing the paper back.

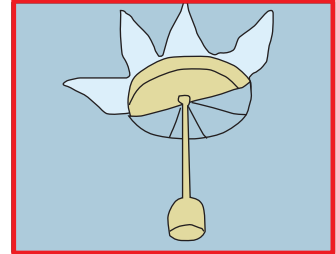

Hang paper down over the frame lightly and mark position of corners. Cut from waste area of paper in towards these marks. Gently smooth paper down against wall and into edges of frame. Mark and trim in normal way.

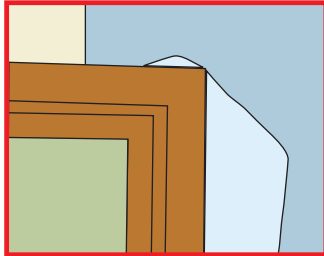

Take your paper around corner by about $\pm 15\text{mm}$ and trim it to this point. The next section of paper can then be hung vertically, overlapping this $\pm 15\text{mm}$ and trimmed a fraction back from the corner.

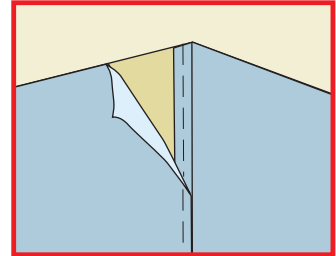

Hang the length that overlaps the recess. Cut a horizontal line a fraction above the head of the window, back to top corner of recess. Cut a line a fraction below the top of the sill, back to bottom corner of the recess. Allowing for pattern matching and trimming, cut a piece to suit the recess at the top, as if it were a continuation of the length just hung. Paste piece and position it, aligning the pattern. Slide front edge up under the main length. Trim the two pieces just above the head of the window, using a sharp blade and straight edge. Remove offcuts and smooth down. Continue papering above and below recessed frame, treating top as an external angle. Treat far side exactly the same as the first side of the recess.

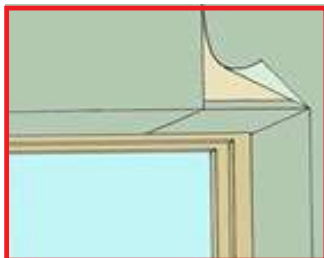

**SHOULD YOU HAVE ANY FURTHER QUESTIONS,
PLEASE DO NOT HESITATE TO CONTACT
YOUR LOCAL BUILDIT STORE.**

simply 

REGIONAL OFFICES

KWAZULU NATAL 031 508 5000	EASTERN CAPE 041 404 5000	WESTERN CAPE 021 550 7300	LOWVELD 013 753 6800
SWAZILAND 013 753 6800	SOUTH RAND 011 821 4000	NORTH RAND 011 203 5300	NAMIBIA 00264 61214201

© 2006 BUILD IT

E & O. E.

Building made simple!