

*simply*

# Applying Preglued Edging



Edge banding is commonly used in home decorating. It is intended to help the user change the style and look of the grain in the wood. Eg. a plywood table can be changed to look like maple with the use of veneers and edge banding. This leaflet details the application of edge banding.

#### TOOLS REQUIRED

Scissors  
Iron  
Roller/Block of Wood  
Edge Trimmer  
Utility Knife

# Building made simple!

simply

# Applying Preglued Edging

## 1. PREPARE SURFACE EDGE

- Fill any large holes
- Sand rough spots
- Remove sawdust
- Cut edging 1,5cm longer than surface to be covered

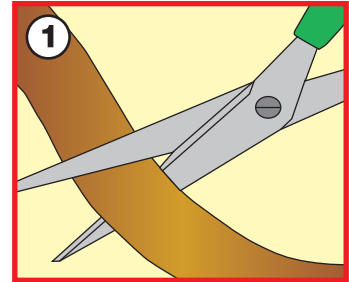

## 2. APPLY EDGING

- Preheat iron on “cotton” setting
- Position edging
- Slowly press iron over length of edging
- Check to see if glue is melting

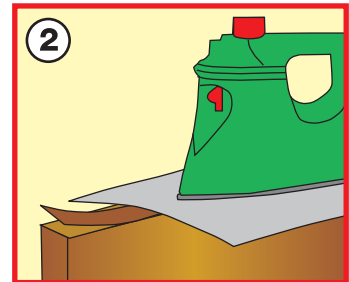

**NOTE :** Use kraft paper or aluminium foil to protect iron bottom

## 3. BONDING

- While still hot, press edging down firmly with wood block or roller.
- If mistakes should occur, simply reheat and reapply

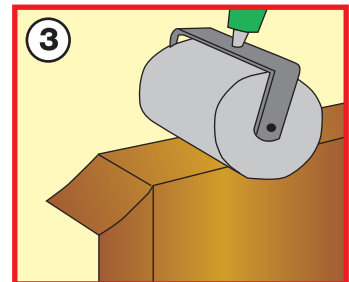

## 4. TRIM EDGE

- Allow edging to cool completely
- Trim excess with an edge trimmer or utility knife
- Sand wood veneer smooth and finish as desired

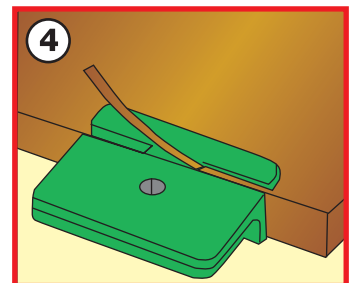

simply  
Build it

SHOULD YOU HAVE ANY FURTHER QUESTIONS, PLEASE DO NOT HESITATE TO CONTACT YOUR LOCAL BUILD IT STORE.

### REGIONAL OFFICES

<b>KWAZULU NATAL</b> 031 508 5000	<b>EASTERN CAPE</b> 041 404 5000	<b>WESTERN CAPE</b> 021 550 7300	<b>LOWVELD</b> 013 753 6800
<b>SWAZILAND</b> 013 753 6800	<b>SOUTH RAND</b> 011 821 4000	<b>NORTH RAND</b> 011 203 5300	<b>NAMIBIA</b> 00264 61214201

© 2006 BUILD IT

E & O. E.

# Building made simple!